

Instruction Manual

800 Yards Remote Dog Training Collar
Rechargeable & Waterproof & Portable Training
Collar with Automation, Static Shock, Vibration,
Beep & Intensity Adjustment & LCD Screen

Model Number: 160



⚠ WARNING

Do not use this product for your aggressive dog, or if your dog is prone to aggressive behavior. Aggressive dogs may cause damage to the people or things around. If you are unsure whether this product is appropriate for your dog, please consult your veterinarian or certified trainer.

CAUTION:

Risk of skin damage. Please read and follow the instructions. It is important to use the collar correctly. Too tight for wearing may cause skin damage.

*Avoid wearing the collar on the dog for more than 12 hours per day.

*If possible, reposition the collar every 1 to 2 hours.

*Check the collar to prevent excessive pressure, just follow the instruction.

*Never connect a dog rope to the collar, it will cause excessive pressure on the contact area.

*Wash the neck area of your dog and the contact area of the collar weekly with a damp cloth.

*Examine the contact area of dog daily, lest rash or sore appears.

These cautions will help to keep your pet safe and comfortable.

Packing List:

- 1 X Remote
- 1 X Receiver
- 1 X Nylon Belt
- 1 X USB Charging Cable
- 1 X Charger
- 1 X Test Bulb
- 1 x User Manual



MAIN FEATURES

1. Easy-to-use, ergonomic transmitter.
2. Rainproof receiver for bad weather training.
3. Rechargeable collar and transmitter.
4. 4 training modes: static shock/ vibration/ beep/ automation.
5. Adjustable Intensity under static shock/vibration/automation mode from 1 to 7 levels.
6. The remote control distance of this product is 800 yards.
7. Two-dog model allows trainers to control two dogs from one transmitter.
8. Power saving design with automatic standby and memory function. (With memory function, if the transmitter and the receiver do not run out of power, the product can work by just turning on the transmitter and the receiver. In this case, there is no need to pair them again.)
9. No external antenna on the collar receiver.
10. This collar is ideal for small, medium, and big size dogs.

DESCRIPTION

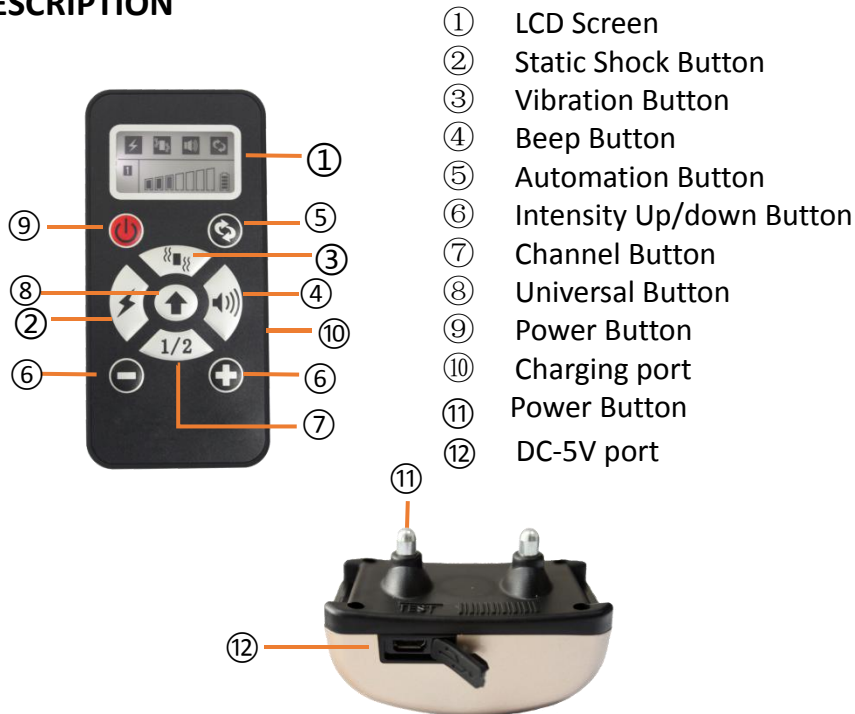

1. LCD Screen:

The LCD Screen will display different modes of the collar and the different channels for two collar receivers as well as battery indication.

Channel 1: Indicates the selection of the first collar receiver.

Channel 2: Indicates the selection of the second collar receiver.

2. Static Shock Button: Pressing the “Static Shock” button, the receiver will emit shock.

3. Vibration Button: Pressing the “Vibration” button, the receiver will vibrate.

4. Beep Button: Pressing the “Beep” button, the receiver will emit a beep sound.

5. Automation Button: Pressing the “Automation” button, the receiver will change to automatic mode. Under automatic mode, when the dog yells, the product will vibrate and then shock.

6. Intensity Up/down Buttons: Selects intensity level of the vibration and static Shock, selects the sensitivity of automation mode.

7. Channel Button: Pressing this “1/2” button will shift channel between the first and second collar receiver.

8. Universal Button: Sends the signal from transmitter to receiver, resulting in stimulation, depending on your mode selection. (For example, when vibration mode is chosen, pressing the vibration or universal button can send out vibration signal.)

9. Turn on/off the transmitter: Turn on/off the transmitter by press the “Power” button one time.

10. Charging port: Insert charging cable into charging port to charge the Transmitter.

11. Turn on/off the Receiver: Turn on/off the receiver by press the “Power” button one time.

12. DV-5V hole: Insert charging cable into DC-5V port to charge the receiver.

HOW TO USE

Note: Please charge before using the product!

1.Charge the remote transmitter:

- 1) Connect the charger cable to the charging port.
- 2) Plug the charger into a standard outlet.
- 3)The icon of battery will flash.
- 4) Charge the transmitter for about one hour for the first charge or until the icon of battery stops flashing.

2.Charge the collar receiver:

- 1) Connect the charger cable to the DC-5V port.
- 2) Plug the charger into a standard wall outlet.
- 3) The red light will flash on the receiver
(If not or green light ,please plug the charger again).
- 4) Charge the receiver for about one hour for the first charge or until the light indicates charging complete.

3.Connect transmitter and receiver

- 1) Turn on the transmitter.
- 2) Press "1/2" button to choose channel 1 for pairing.
- 3)Turn on the receiver
- 4)Press the "Power"button on the receiver again.
- 5) After a beep from the receiver, press the "Vibration button" within 30 seconds for pairing.
- 6) The collar receiver will beep if connected successfully.
- 7)If the pairing were not successful, please repeat the 3-5 steps.
- 8) To match the second receiver, press the "1/2"button and select for the second receiver and follow the same procedure.

4.How to change to fully automation mode:

Press down the“Automation” Button and the receiver will send out “Beep Beep” sound which indicates that it is changed to the automation mode.

5.How to test automation mode:

Connect the test bulb to the two metal screws on the receiver, gently scratch the test area on the receiver, the receiver will vibrate first and shock afterwards.

6.How to adjust the sensitivity under the automation mode:

After entering into the automation mode, press down "+"or"-" button to adjust the sensitivity and **press the automation button again.**(The level 7 is the most sensitive,the level 1 is the most insensitive.)

7.How to adjust the level of the vibration and shock under the automation mode:

Switch to the manual mode, press the "+" or "-" button to adjust to the level of vibration and shock that works best with your dog, then press the “Automation” button again to re-enter automatic mode.

8.What is the Automatic Anti-bark mode?

When you enter automatic mode, if the dog barks collar will vibrate then send shock.

Before you enter this mode, be sure to set the level of vibration and shock. We recommend beginning with lowest vibration and shock level.

Notes

1. In common, if the battery is full, the receiver can work for 10 days, and the transmitter 20 days.

2. The valid distance of the remote means the straight-line distance between the Transmitter and the Collar Receiver without obstacles in between. If there are interference signals or other disruptions, the actual remote control distance may be variable.

3. Training sessions should be kept positive and short, 10-15 minutes for each session is recommended.

4. Presently, this product is the most effective and safest tool for training or barking prevention.Follow the correct operational instructions , you can effectively train the pet without any problems.

Operation Steps:

1. Turn on the transmitter



2. Turn on the receiver

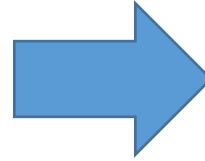

3. Press the the "power" button once again, the red light will light up and you will hear "Beep"



Note:

In automation mode, the sensitivity can be adjusted. Please choose the correct sensitivity level, according to your dogs. You can refer to page 5, the seventh step.

Under automation mode, in order to ensure the safety of the dog, the product will enter the protected mode after work for 5 times consecutively. When in protected mode, the product will not work no matter how the dog barks. It is required to wait for minutes or press the "Automation" button to activate the product.

The sound of this product is not adjustable.

4. Press the "Static Shock" button on the transmitter, and you will hear "Beep" again which means this product has been matched complete. Use the test bulb to test the shock.



6

7

Test bulb

How to test automation mode:

2.This means that it is already in automation mode



1.Press the “Automation” button of the transmitter, you will hear “beep beep” from the receiver

3.Connect the Test bulb to the mental screws on the Receiver, gently scratch the Test Area, the receiver will vibrate first and shock afterwards.If you want to adjust the sensitivity level,you can refer to page 5,the seventh step.



How to use two receivers at the same time:



1.Press the “1/2” button to choose channel 1 for pairing, then follow the “Operation Steps” to pair it.

8

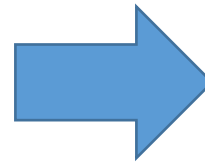

2.Press the “1/2” button to choose channel 2 for pairing, then follow the “Operation Steps” to pair it.

9

Important Notice:

1. The transmitter will be changed to Standby Mode if there is no operations after 5 seconds .The receiver will be changed to Standby Mode if there is no operations for one minute. Any movements from the dog will activate the receiver.
2. Press "1/2" button for selection. Channel 1 controls the first receiver and Channel 2 controls the second receiver.
3. In working mode, if you want to reconnect the receiver to the transmitter, simply press the "Power" button, there will be a beep sound indicating that it is ready to be matched.
4. The design of the receiver is rainproof. The rubber cover has to be put in the right position to ensure rainproof effect.
5. Test static shock function:
 - 1) Place the Test bulb to the metal screws (ensure the metal points are attached when test the shock function).
 - 2) Press the "Static Shock" button, and the LED light will flash on.
6. how to choose the right shock level?

When the dog's weight is less than 11lb, it is recommended to use vibration

When the dog's weight: 11-22lb, it is recommended to use the 1 level shock

When the dog's weight: 22-33lb, it is recommended to use the 2 level shock

When the dog's weight: 33-44lb, it is recommended to use the 3 level shock

When the dog's weight: 44-55lb, it is recommended to use the 4 level shock

When the dog's weight: 55-66lb, it is recommended to use the 5 level shock

When the dog's weight: 66-77lb, it is recommended to use the 6 level shock

When the weight of the dog is more than 77lb, it is recommended to use the 7 level shock

When using the electric shock, please select the appropriate electrical shock level according to the weight of the dog.

Frequently Asked Questions

Q:Can I use Training Collar with more than one pet?

A:Yes,you can simply add one more receiver collar to the system.

Q:Will I get exactly 800 yards of range with the Remote Trainer?

A:The effective range of the Remote Trainer means the straight-line distance between Remote Trasmmitter and Receiver Collar without obstacles in between.Range may be variable according to terrain,weather,vegetation,battery capability as well as the transmission from other radio devices.

Q:How long can I continuously deliver vibration or static shock to my pet?

A:The maximum amount of time you can press the vibration or static shock to your pet continously is 10 seconds.After this,the vibration or static shock will stop, and the button must be released and pressed again.

Q:What do I do if my pet's neck becomes red and irritated?

A:Discontinue to use the product for a few days.If the condition persists beyond 48 hours,consult your veterinarian for help. Once the skin recovers, check the skin condition of your pet frequently.

Q:How long is the lifetime of the lithium battery ?

A:Our Lithium battery can charge 2000 times for Remote Controller and Receiver Collar.

Q:How long can I remove the Receiver Collar from my dog?

A:The Collar is not designed to be worn constanly.We recommend the Collar not be worn for more than 12 hour of every 24-hour period.

Q:How long should I process my training session for my pet?

A:Training sessions should be kept positive and short ,it is better for about 10-15 minutes each time.

Q:What kind of dogs are your training collar suitable for?

A:The collar is adjustable from length 5.9"(15cm)to 19.6"(50cm),if your pet's neck is smaller than 5.9",you have to rethread it,if your pet's neck is larger than 22",please don't buy it and this collar is not suitable for the dogs less than 8 pounds either.

Common size of different dogs

Size	Neck	Chest Measurement(cm)	Back Length(cm)	Type
Mini	20-22	25-30	19	Chihuahua, Yorkshire Terrier
Small	20-24	29-36	23	Chihuahua, Yorkshire Terrier, Poodle, Pomeranian
Medium	23-28	35-42	28	Maltese Dog, Shih Tzu
Large	27-31	41-47	31	Miniature Schnauzer, Pekingese
Large	30-34	46-53	35	Schnauzer, English Cocker Spaniel
Large	33-37	52-59	40	Beagle
Huge	43-48	76-84	60	Husky

General Training Tips

The following tips will show you how to get the best performance out of your Dog Training Collar.

- (1) Make training sessions short and positive (about 10-15 minutes for each session.) This will enable the dog to focus on the trainer.
- (2) Training one dog each time is recommended.

- (3) During the first initial training sessions, keep the dog in a familiar outdoor environment. Training in a place that the dog is not familiar with may make the dog become distracted.
- (4) Use a long leash fastened to a non-metallic collar to help the dog to learn. Ensure that the additional collar and leash does not interfere with the Contact Points of the Collar Receiver. Do not use the remote training collar without a long leash unless your dog is fully trained.
- (5) More success will occur by teaching the dog a command first before trying to reinforce the command with the Remote Transmitter.
- (6) For basic obedience training, vibration is more useful.
- (7) Issue one obedience command each time, this will reduce confusion and allow the dog to remain focused. Do not use the training system for commands that the dog has not learned.
- (8) During training, look for all the positive changes in the dog's behavior and remember to encourage it promptly with ample praise and reward.
- (9) Avoid over-correcting your dog. Use as little remote correction as possible during the training process.
- (10) When the dog has become apparently perplexed, shift the focus of the training by drawing the dog's attention to a command they have been familiar with.
Example: Tell the dog to sit and give abundant praise and encouragement on successful completion of the sit command.
- (11) Do not use the training system to correct or eliminate aggressive or biting behavior. When the dog is showing signs of aggressive behavior, contact a professional dog trainer in your local area immediately.
- (12) Please keep in mind that training sessions should be kept short. Stop Training and play with the dog when the dog has made progress.